

PK Engineering (WB) Ltd  
Unit 2/3 Exchange Works  
Kelvin Way  
West Bromwich  
West Midlands  
B70 7JW

T: 0121 500 5847

E: [sales@pk-engineering.co.uk](mailto:sales@pk-engineering.co.uk)

[www.pk-engineering.co.uk](http://www.pk-engineering.co.uk)



PK ENGINEERING

T U R N K E Y P R E C I S I O N E N G I N E E R I N G

# WHO WE ARE

## OUR STORY

PK Engineering (WB) Ltd is a family run business established in the early 80s. We are specialists in CNC production work with over 30 years engineering experience. This has allowed us to recognise our customers' requirements and to become an efficient and innovative organisation that thrives on professionalism and quality.

Our strength lies in our ability to organise our assets, both physical and human, for maximum productivity ensuring our products and services are delivered to the highest standards.

We are innovative and not complacent, forward thinking and up to date with the latest technologies. We have continuously invested in machinery, tooling and inspection equipment to include the latest CITIZEN SLIDING HEAD machinery with LfV technology and the latest five axis CNC machining centres.

Our skilled engineers specialise in CNC Turning, CNC Milling, Multi-spindle Autos, CNC Tube Manipulation, Automatic Sawing and Grinding. This gives us the capability to produce a "one-off" to any batch size depending on our customers' order requisite and lead time factors.

## VISION

Our vision is to go above and beyond in all that we do, by consistently being professional, efficient and innovative, exceeding customer expectations to be the preferred manufacturer of choice.

## VALUES

- Efficiency
- Quality
- Professionalism
- Respect
- Integrity
- Passion
- Innovation
- Autonomy

*"We must always adhere to our values, vision and mission"*

## MISSION

To attain excellence and be the preferred contract manufacturing choice. We will invest in new technology and collaborate within the supply chain to provide cost effective and on time delivery engineering solutions for our customers.

We will drive innovation and continuous improvement, remain quality focused, nurture and empower the team to maintain a highly skilled, committed and talented workforce.



## INVESTMENT

We are very proud of our investment record, a programme that has seen all our machines continually upgraded to the latest specification. This, allied with our commitment to employee training, ensures our confidence in supplying a service second to none. We are also committed to apprenticeships and training of young people, having the local community at heart.



**ISO 9001: 2015**  
Quality Management  
FM11672



**INVESTORS  
IN PEOPLE**



# CAPABILITIES

## QUALITY

We have a wide range of inspection equipment to check a variety of dimensions to exacting tolerances. All gauges and instruments are calibrated following our ISO 9001 process.

Quality is integral to our operations and we complete an Initial Sample Inspection Report (ISIR) for each job regardless of how many times we have made it before.

We have a dedicated in house inspection capacity which is able to carry out a "Production Part Approval Process" (PPAP) when required.

## SERVICES

- Precision Engineering • Prototype Engineering • CNC Production Engineers
- Hydraulic Component Specialist • Specialists Fabrications • Kanban Stock Facility
- Overseas CNC manufacturing facilities • ISO 9001 Approved



MILLING

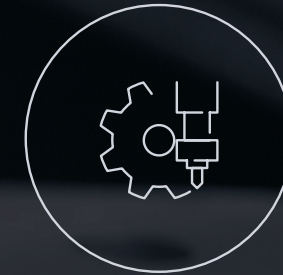

COMPLEX MILLING



3D MILLING



CNC MACHINE



CNC TURNING



CNC FILES



CNC PROGRAM



MILLING ENGRAVING



COMPLEX CUTTING





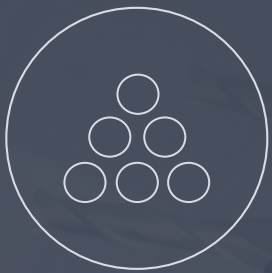

## MATERIALS

Most types of materials can be machined by our CNC machines. Common materials include metals such as mild steels, stainless steel, aluminium, brass, copper and titanium, as well as the harder exotic materials such as Inconel and Super Duplex steels. With the very latest LFV technology added as an optional extra on our sliding heads, we are able to machine plastics and copper without the entanglement of swarf that generally occurs on these types of materials.

## CITIZEN SLIDING HEADS

The highly flexible and efficient Cincom range of sliding head automatic lathes combines high quality standards with cost-effective manufacturing and shares the worldwide success of Citizen watches. Cincom turning machines represent the very latest in technological advances. Their latest LFV technology allows us to program the size of swarf chip to prevent entanglement, helping to increase tool life and surface finish. The robust construction of these machines and user-friendly high speed control systems provide impressive machining accuracy.

# CAPACITY

## CNC TURNING

- CNC PUMA 350M WITH 'C' AXIS
- 4 X MORI SEIKI SLO
- MORI SEIKI SL15 BAR FEED CNC
- AKEBONO BAR FEED CNC WITH 2ND OP SPINDLE
- HITACHI SEIKI BAR FEED CNC
- 2 X MORI SEIKI SL1 BARFEED CNC
- ACT 3 BAR FEED CNC
- GEMTURN CNC
- 3 X PUMA 10HC
- 2 X CMZ 'C' AXIS
- ECOCA SJ15
- 4 X CITIZEN L32 TYPE XII SLIDING HEADS LFV
- 1 X CITIZEN L220 SLIDING HEAD LFV
- 1 X PUMA LYNX 220 BAR FEED

## CNC MILLING

- 2 x DOOSAN DNM750L II – C/W NIKKEN 4TH AXIS
- VICTOR VCENTRE-80 MACHINING CENTRE C/W NIKKEN 4TH AXIS
- HITACHI SEIKI
- MITSUBISHI M-V5CN
- OKK PCV-60
- BRIDGEPORT INTERACT 1020X C/W 4TH AXIS
- 2 x DOOSAN DVF5000 – 5 AXIS MACHINING CENTRE
- 2 x BRIDGEPORT MANUAL WITH DRO

## MULTISPINDLE AUTO'S

- 6 X 1" SIX SPINDLE WICKMANS
- 3 X 1-3/4" SIX SPINDLE WICKMANS

## INSPECTION

- HEXAGON DEA GLOBAL CMM 700mmx700mmx500mm With A State Of The Art Rc 1 Controller. Latest Pc-Dmis Software
- 2 x MITUTOYO PROFILE PROJECTORS
- 2 x FARO GAGE ARMS
- MITUTOYO SURFTEST SJ-210

## CAD/CAM SUITES

- AUTODESK POWERSHAPE
- AUTODESK POWERMILL
- CAMTEK PEPS
- AUTOCAD LT

## MARKING FACILITY

- PROPEN MARKING MACHINE

## TUBE MANIPULATION

- LANGBOW SEMI AUTOMATIC TUBE BENDER

## MISC

- AUTOMATIC SAW OFF MACHINE
- VIBRO DEBURRING
- 30 TONNE HARE BROACH



## WHAT WE MAKE



CNC milling machine is mainly used for the processing of various complex plane, curved surface, and shell parts, for example, various kinds of cam, die, connecting rod, blade, propeller, box, and housing shape parts are machined by CNC milling process. In a word, typical CNC milling parts can be divided into three categories: plane parts, surface parts, and angle parts.

Each machine has its own accuracy level and machining sequences. Sometimes, several CNC machines will employ to make certain components.

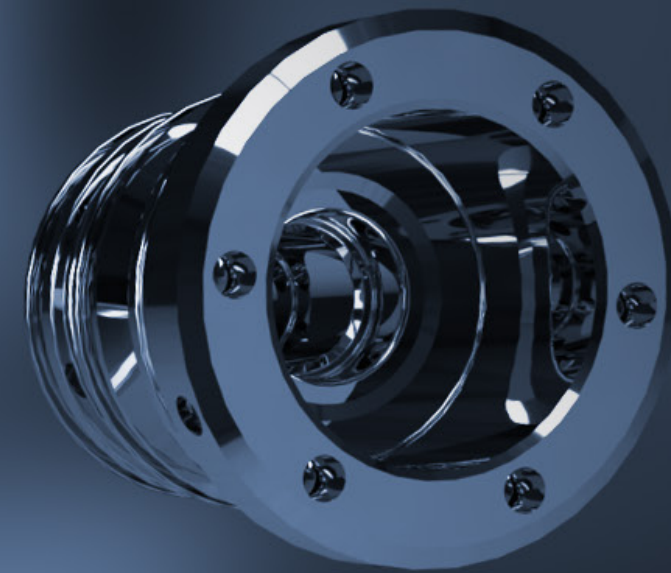
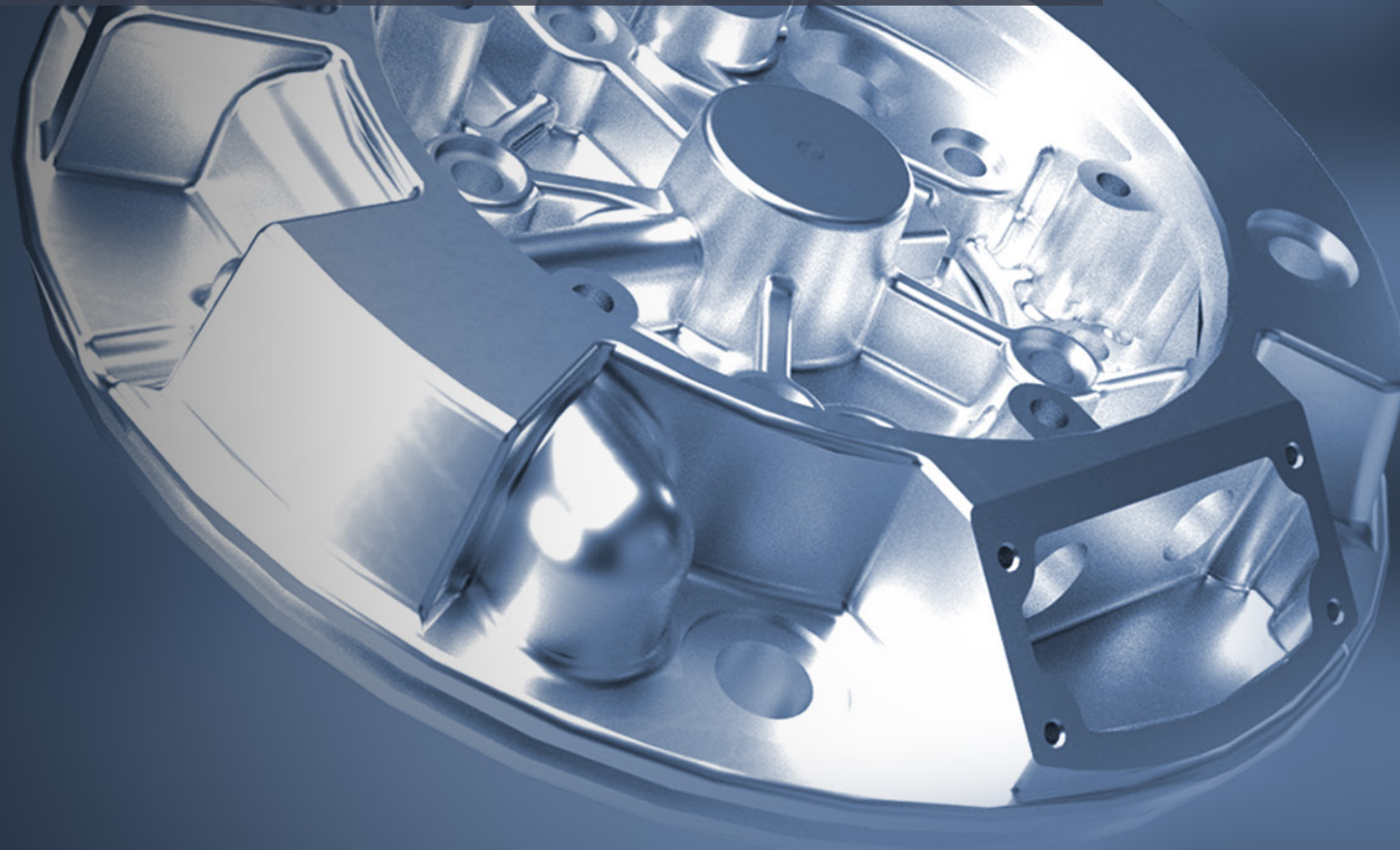

# PRODUCTS

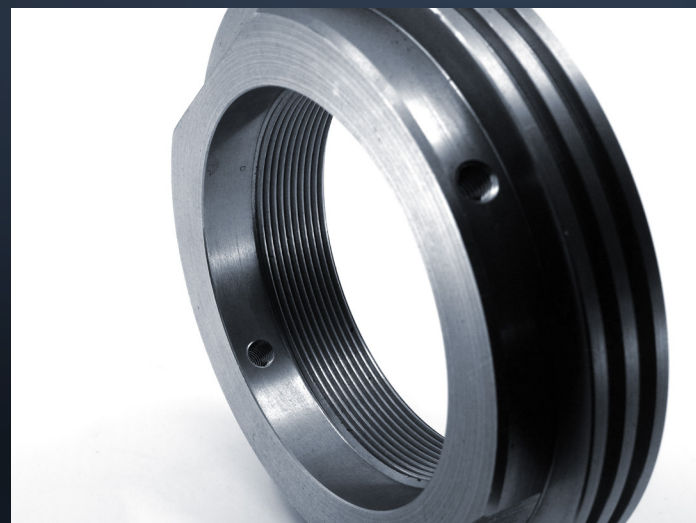

## OUR PRODUCTS

With CNC technology and various kinds of cutting tools, you can make almost anything on CNC machines, from marine parts, mechanical parts to aviation parts, those parts are often high precision parts including shafts, gears, bushings, flywheels, cam, mold, propeller, etc.

The product that you can make on a CNC machine depends on the type of machine you are using. Each type of CNC machines has its own machining capability, and are used for making unique nature of components. For example, a round or spherical component producing in a CNC turning center cannot be produced in a CNC milling machine. A component that producing from a milling machine cannot be produced from a CNC lathe and so on.



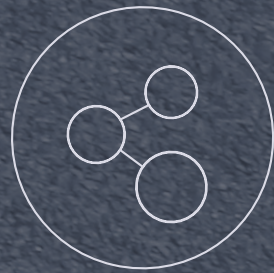

## INDUSTRIES

- DEFENCE
- PHARMACEUTICALS
- MEDICAL
- OIL EXPLORATION
- ENERGY GENERATION
- AUTOMOTIVE
- COMMUNICATION

# OUR CLIENTS

## SECTORS SERVED

Utilising a wealth of industry experience and knowledge within a variety of diverse quality critical sectors, coupled with the required compliance to meet individual industry standards, we have the capability and approvals to supply complex components in a variety of materials, to customer specification, on time and right first time.

Additionally, whilst understanding the general and routine compliance requirements relating to component supply, we also understand each industry sector's specific requirements relating to compliance and possess full appreciation of the ultimate end user requirements.



## GLOBAL

We are proud that our products are used worldwide covering industries including, Defence, Pharmaceuticals, Medical, Oil Exploration, Energy Generation and Commercial Automotive Industry.



## OVERVIEW

- Turnkey Precision High/Low Volume CNC machined components
- ISO 9001:2015 Quality Management System
- Family run business with over 30 years industry experience
- Proud of our large investments in machinery and employee training
- Temperature controlled inspection facility
- Technological investments ensures our competitiveness in today's market place
- Wide range of industries and sectors served
- Dedicated to customer satisfaction

PK Engineering (WB) Ltd  
Unit 2/3 Exchange Works  
Kelvin Way  
West Bromwich  
West Midlands  
B70 7JW

T: 0121 500 5847

E: [sales@pk-engineering.co.uk](mailto:sales@pk-engineering.co.uk)

[www.pk-engineering.co.uk](http://www.pk-engineering.co.uk)



ISO 9001:2015  
Quality Management  
FM11672



INVESTORS  
IN PEOPLE



